

# THE PONANT EXPLORERS

*Le Lapérouse, Le Champlain, Le Bougainville,  
Le Dumont-d'Urville, Le Bellot & Le Jacques-Cartier*



*Take a tour of the Ponant Explorers*

SCAN THIS QR CODE WITH YOUR SMARTPHONE'S CAMERA AND TAKE A 360° TOUR OF THE SHIPS!



# DECK PLANS

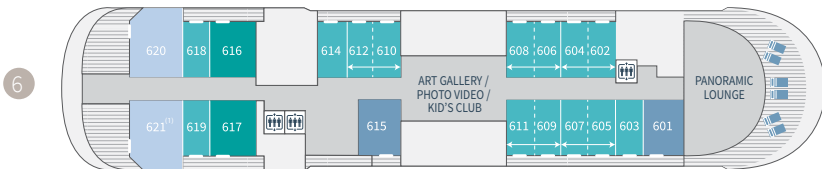
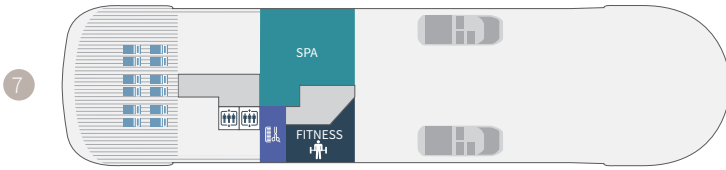

<sup>(1)</sup> Aboard *Le Lapérouse* and *Le Champlain*, the Owner's Suite is located on deck 6 (Suite 621)



<sup>(2)</sup> Aboard *Le Lapérouse* and *Le Champlain*, the Suites 534 and 535 located on deck 5 are Grand Deluxe Suites.

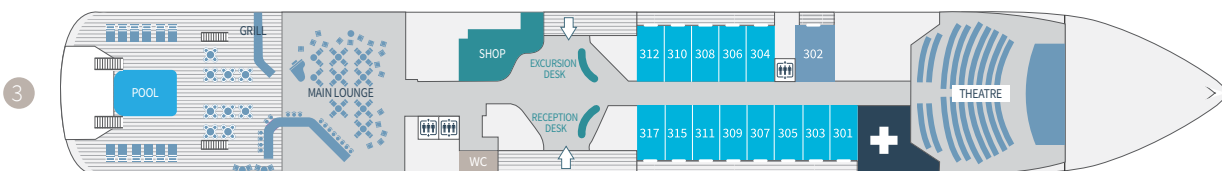
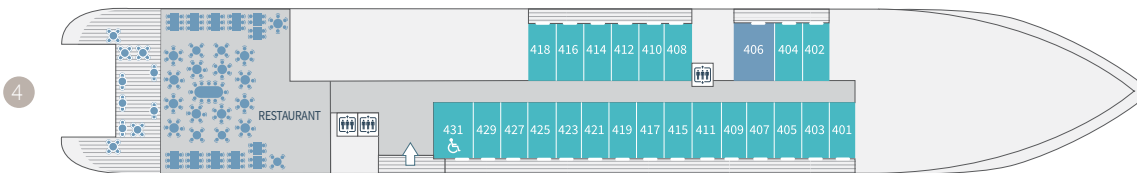

- 7 Fitness – Ponant Yacht Spa
- 6 Panoramic lounge – 14 Prestige Staterooms (including 10 Prestige Staterooms convertible into 5 Luxury Suites) – 2 Deluxe Suites – 2 Privilege Suites – 2 Grand Deluxe Suites (except aboard *Le Lapérouse* and *Le Champlain*: 1 Grand Deluxe Suite and 1 Owner's Suite)
- 5 Bridge – 29 Prestige Staterooms (including 1 for person of reduced mobility and 26 Prestige Staterooms convertible into 13 Prestige Suites) – 1 Deluxe Suite – 2 Privilege Suites – 2 Owner's Suites (except aboard *Le Lapérouse* and *Le Champlain*: 2 Grand Deluxe Suites)
- 4 Restaurant – 23 Prestige Staterooms (including 1 for person of reduced mobility) – 1 Deluxe Suite
- 3 Reception Desk – Excursion Desk – Main Lounge – Pool Deck – Shop – Medical Centre – Theatre – 13 Deluxe Staterooms – 1 Deluxe Suite
- 2 Marina
- 0 *Blue Eye* underwater lounge

<span style="color: #004a7c;">■</span> Owner's Suite Deck 5 (Deck 6 aboard <i>Le Lapérouse</i> and <i>Le Champlain</i> )	<span style="color: #00838f;">■</span> Grand Deluxe Suites Deck 5 – 6	<span style="color: #004a7c;">■</span> Deluxe Suites Deck 3 – 4 – 5 – 6	<span style="color: #00838f;">■</span> Deluxe Staterooms Deck 3
<span style="color: #00838f;">■</span> Privilege Suites Deck 5 – 6	<span style="color: #00838f;">↔</span> Prestige Suites Deck 5 – 6	<span style="color: #00838f;">■</span> Prestige Staterooms Deck 4 – 5 – 6	

# DISCOVER YOUR STATEROOM

## ACCOMMODATION

### OWNER'S SUITE

45 sq.m + 40 sq.m. private terrace\* with hot tub and sliding bay windows  
 484 sq.ft + 430 sq.ft. private terrace\* with hot tub and sliding bay windows

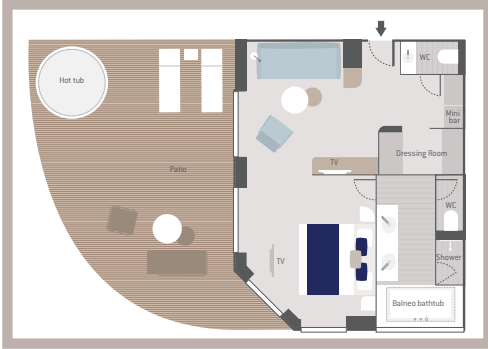

(\*30 sq.m. of private terrace aboard *Le Lapérouse* and *Le Champlain* – 323 sq.ft. of private terrace aboard *Le Lapérouse* and *Le Champlain*)

### 3 GRAND DELUXE SUITES

45 sq.m + 30 sq.m. private terrace and sliding bay windows  
 484 sq.ft + 323 sq.ft. private terrace and sliding bay windows  
 (Deck 5: 40 sq.m. private terrace with hot tub\* and sliding bay windows)

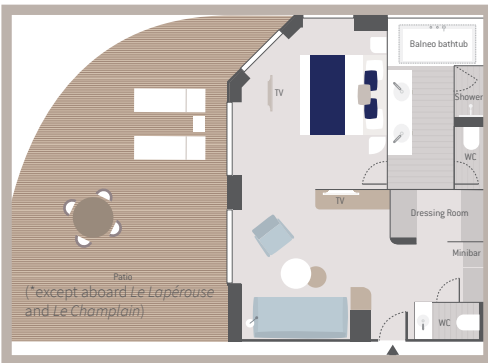

### 4 PRIVILEGE SUITES

32 sq.m + 8 sq.m. private balcony with sliding bay window  
 344 sq.ft + 86 sq.ft. private balcony with sliding bay window

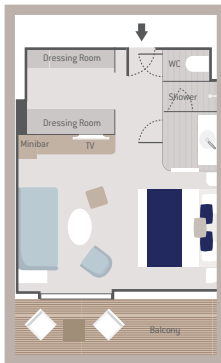

### 18 PRESTIGE SUITES

38 sq.m + 8 sq.m. private balcony with sliding bay window  
 409 sq.ft + 86 sq.ft. private balcony with sliding bay window

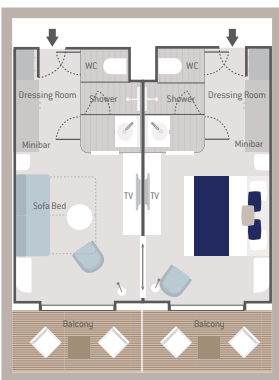

### 66 PRESTIGE STAT.

19 sq.m + 4 sq.m. private balcony with sliding bay window  
 204 sq.ft + 43 sq.ft. private balcony with sliding bay window

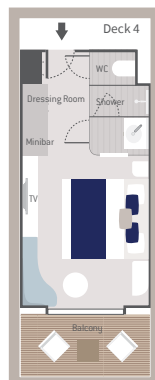

### 5 DELUXE SUITES

27,5 sq.m + 6 sq.m. private balcony with sliding bay window  
 291 sq.ft + 65 sq.ft. private balcony with sliding bay window

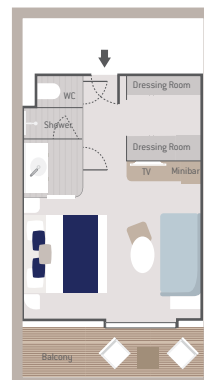

### 13 DELUXE STAT.

19 sq.m + 4 sq.m. private balcony with French window  
 204 sq.ft + 43 sq.ft. private balcony with French window

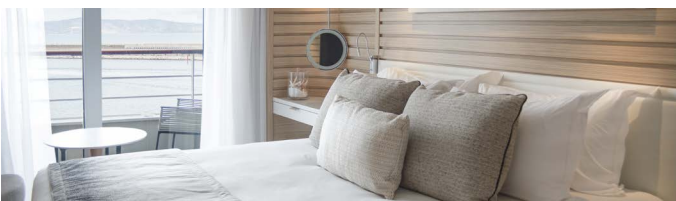
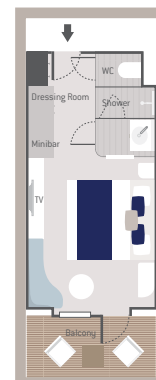

## AMENITIES

- Individually-controlled airconditioning
- Stateroom layout: king-size bed, or twin beds, communicating  
Staterooms available (Children welcome)
- Minibar
- Flat screen satellite TV
- Video on demand
- Bose™ Bluetooth speaker
- Desk with stationery
- Safe
- Hermès® bath products
- Dressing table, bath robes, hairdryer
- Direct line telephone
- 110V American (two flat pins)/220V European  
(round sockets with two round pins)
- 24hr room service
- Inclusive Internet access Wifi

## PUBLIC AREAS

### RECEPTION

140 sq.m. / 1 507 sq.ft. – Reception/concierge desk, excursions desk, ship's administrative services, sales office, 50 sq.m. – 538 sq.ft. shop

### LOUNGES

- **Main Lounge**  
200 sq.m. / 2 153 sq.ft. which can accommodate all our passengers at once for moments of shared conviviality, and as a venue for both daytime and evening shows and entertainment
- **Blue Eye Lounge**  
Multi-sensory underwater lounge which can accommodate 40 guests
- **Panoramic Lounge**  
Library, internet space, bar, and live entertainment on certain evenings  
– Direct access to the panoramic terrace

### RESTAURANTS

- **Grill Restaurant**  
Capacity: 70  
Views out over the pool deck – Grilled meats and a variety of salads and desserts
- **Panoramic Restaurant**  
Capacity: all passengers – Buffet & table service  
– Wine cellar – Wide open on the outside

### RECREATION / RELAXATION

- **Hydraulic platform**  
Much easier onboard access than on any other cruise ship – Easier disembarking and embarking by Zodiac® when participating in expeditions – Swimming and bathing in the sea and various nautical sports, such as kayaking and paddleboarding

- **Pool deck**  
A swimming pool offering panoramic views and equipped with a counter-current system – A pleasant, attractive sun deck – An exterior bar and lounge equipped with armchairs and sofas
- **Theatre**  
188-seat capacity  
Cutting edge audio and lighting technology  
– LED stage background wall enabling the projection of ultra-high resolution media
- **Wellness area**  
Spa in partnership with SOTHYS™: massage and treatment cubicles, beauty care cubicle – KÉRASTASE / L'Oréal Paris hair salon – Free access sauna – Gym

