

VESSEL ODALISQUE III

Specifications

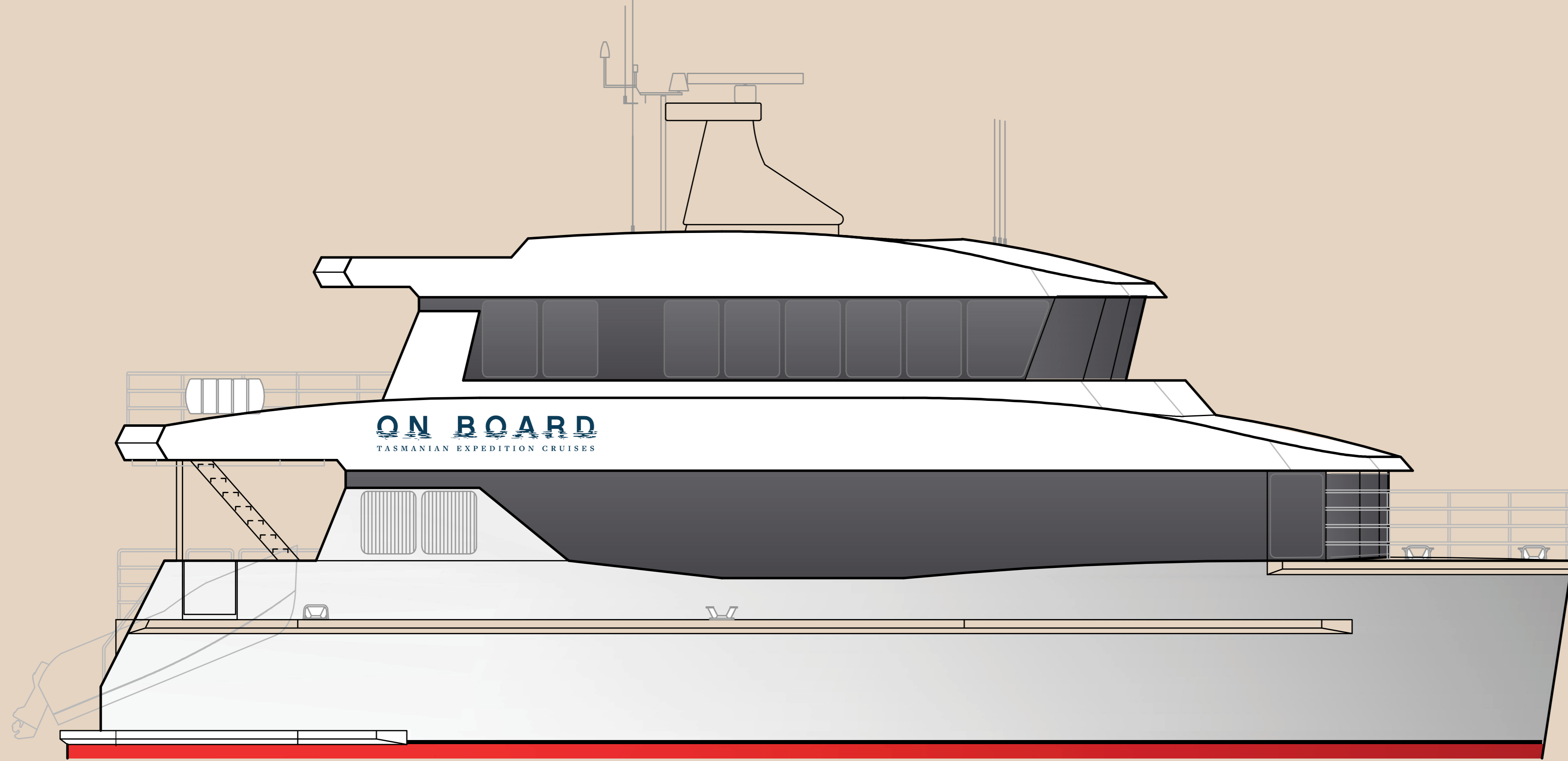

Commissioned : January 2023

Configuration : Expedition
Cruising Catamaran

Length : 24 Metres

Draught : 1.5 Metres

Beam : 8 Metres

Crew : 4

Passengers (Overnight) : 12

Propulsion : 2 x 607kw (820hp)
Scania D13

Cruising Speed : 21 Knots

Fuel Capacity : 16,000 Litres

Freshwater Capacity : 4,000 Litres

Cabin Power : 240v

Tenders : 2 x 5.3m Aluminium Ten-
ders

ON BOARD
TASMANIAN EXPEDITION CRUISES

UPPER DECK - Southwest Suites

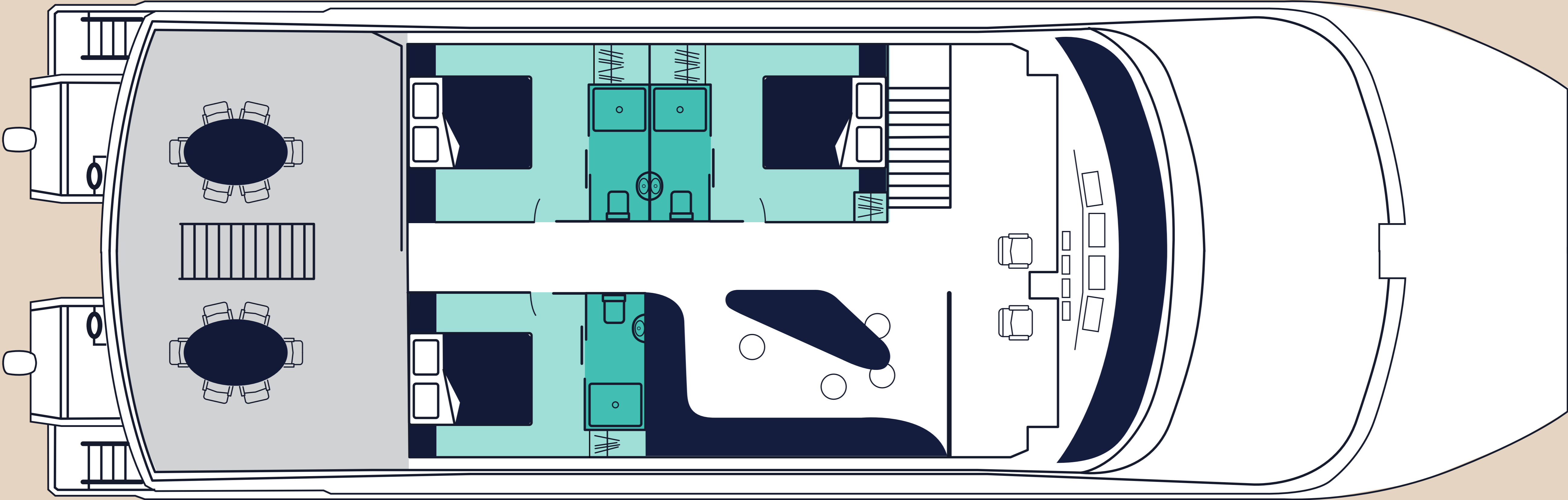

MAIN DECK - Coastal Cabins

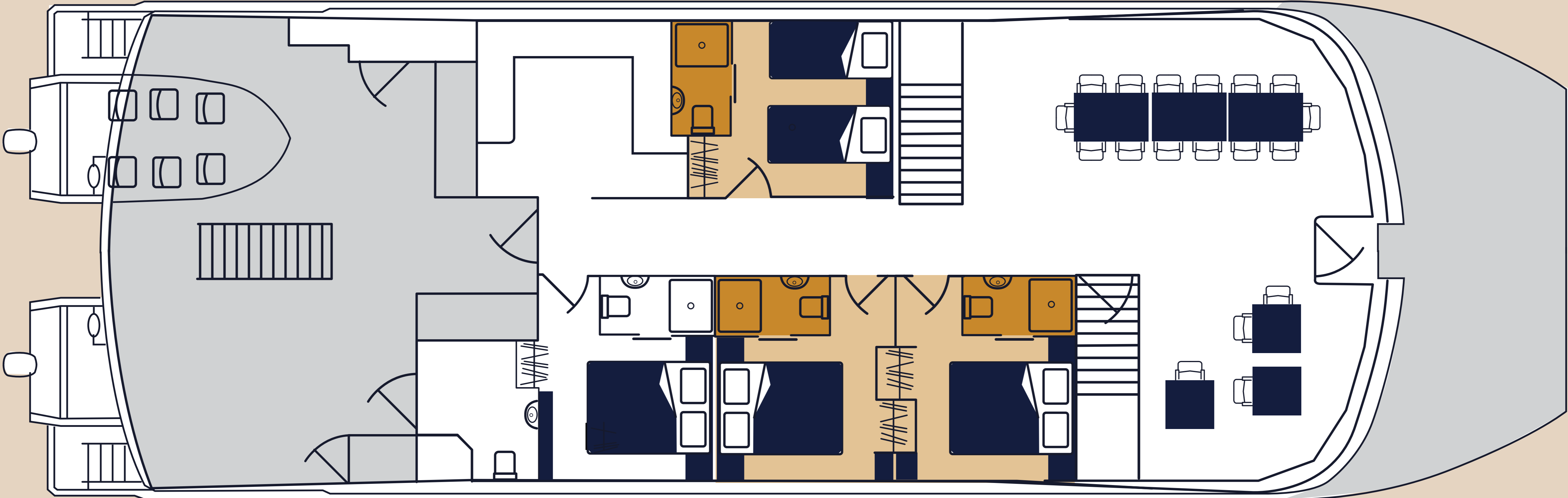

LOWER DECK

